

| | | |
|--|---|--|
| <div>Studio Ingegneria civile</div> <div>Dott. Ing. Luigi De Poi</div> <div>Piazza Duca D'Aosta n. 2</div> <div>CONEGLIANO (TV)</div> <div>C.F. 00514020969</div> <div>P.I. 005215402969</div> <div>TEL. 0438 / 35514</div> <div>FAX 0438 / 35514</div> <div>E. mail: ingegnerluigi@dispoa.virgilio.it</div> | <div>Committente:</div> <div>CANTINA di CONEGLIANO e VITTORIO VENETO s.a.c.</div> <div>già Cantina Sociale Cooperativa di Vittorio Veneto</div> <div>Opera:</div> <div>RISTRUTTURAZIONE CON AMPLIAMENTO</div> <div>art.2 L.R. 32/2013 (piano casa)</div> <div>1° VARIANTE</div> <div>di prop. di ristrutturazione ed ampliamento di fabbricato ex saponificio (p.c. 232 151/172)</div> <div>Oggetto:</div> <div>LUCERNARIO</div> <div>SERRAMENTI P. EST</div> <div>SERRAMENTI P. OVST</div> | <div>Tavola n. :</div> <div>3/A</div> <div>Scala:</div> <div>vedi grafici</div> <div>Controlla:</div> <div>Disegnato da:</div> |
| | <div>Data:</div> <div>02/12/2016</div> <div>Data ogg.:</div> | <div>Note:</div> |
| <div>ACAD -</div> <div>A: 0438 / 351 5000 Fax: 0438 / 3500-5010</div> | | |

PIANTA APERTURE SU LUCERNARIO

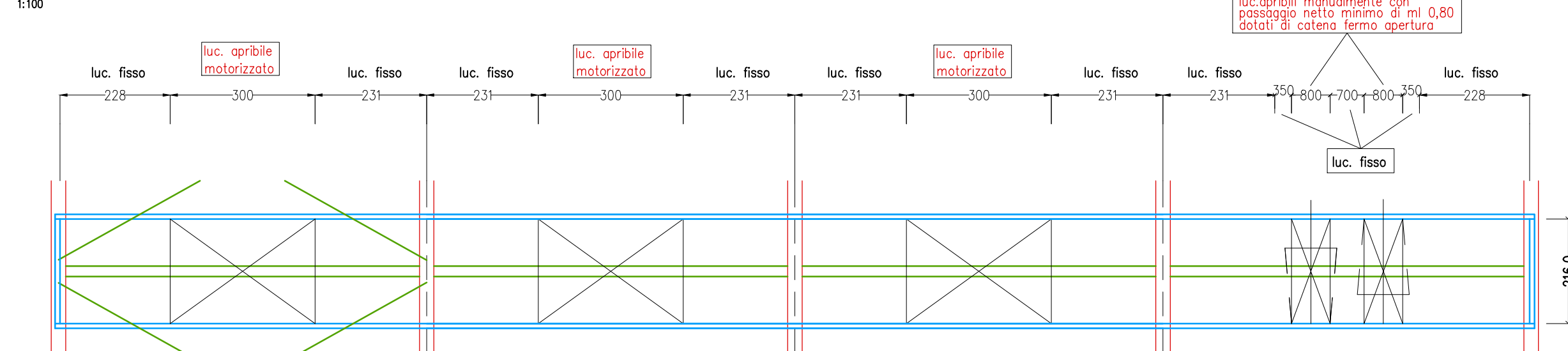

SEZ. LUCERNARIO

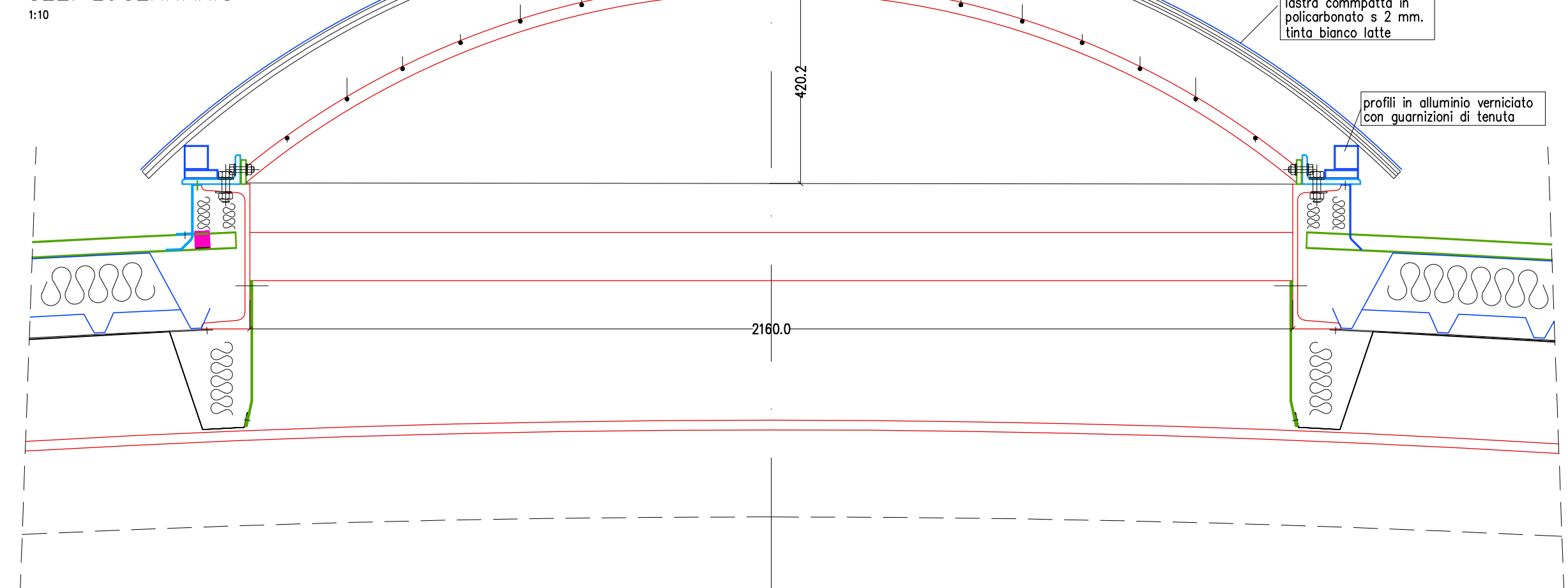

PROSPETTO OVEST

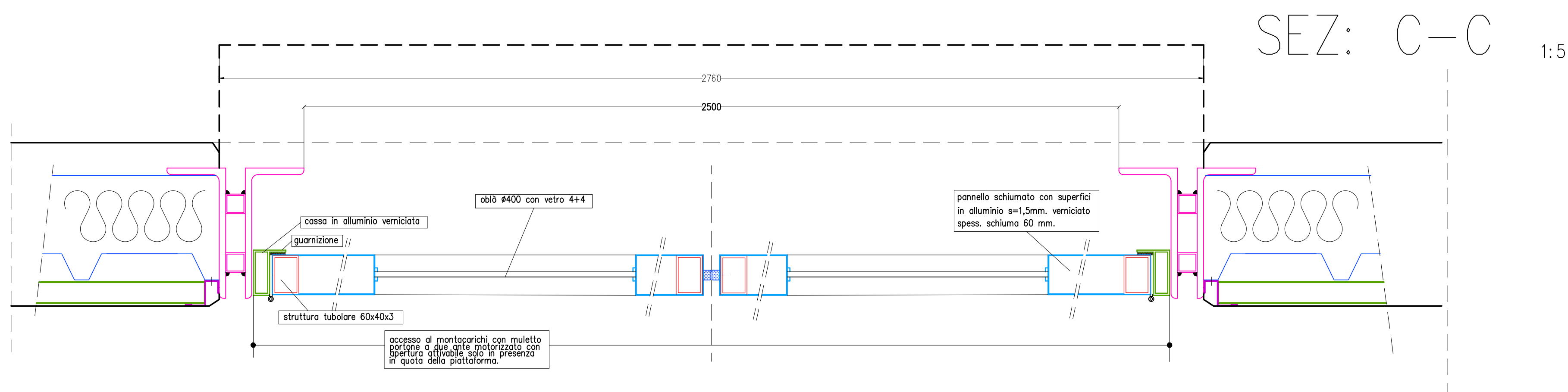
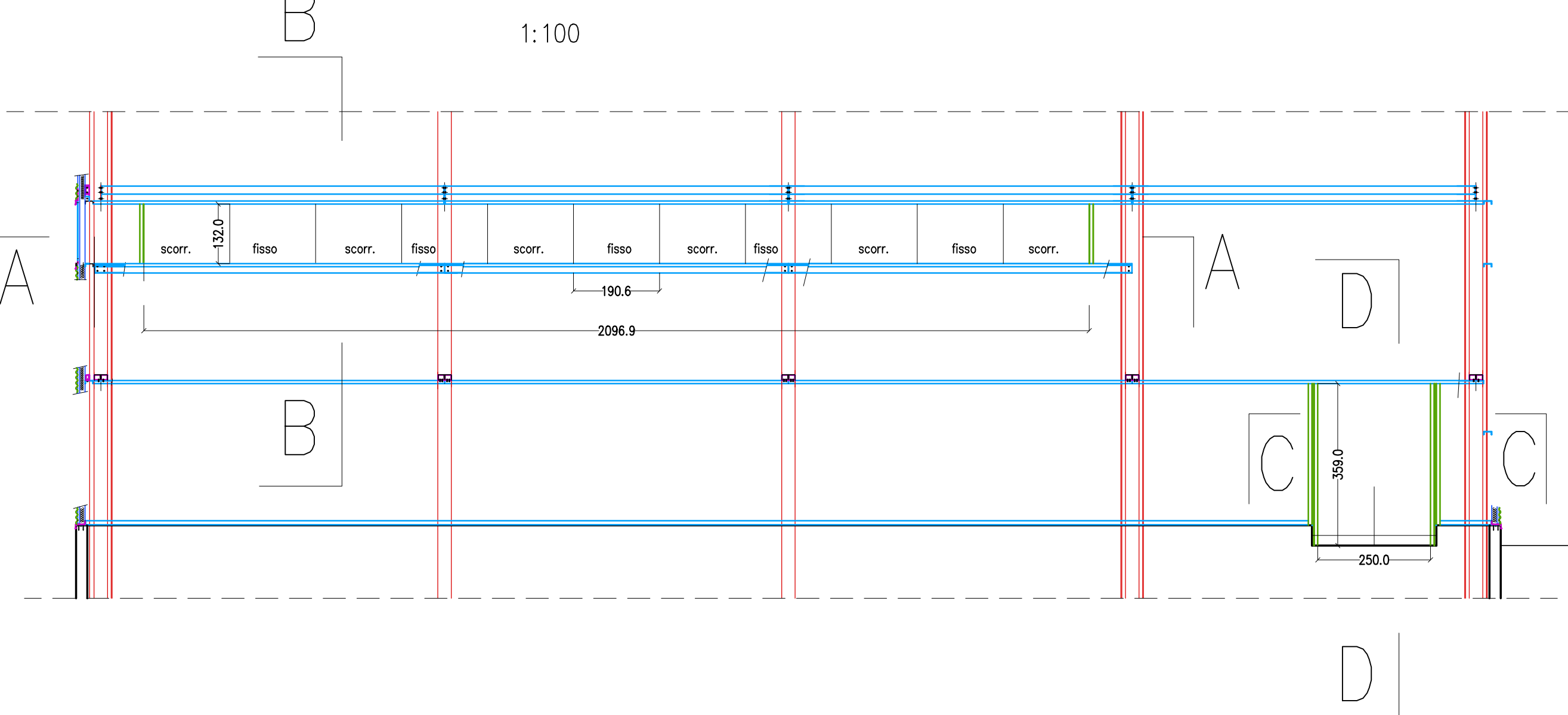

SEZ: D-D

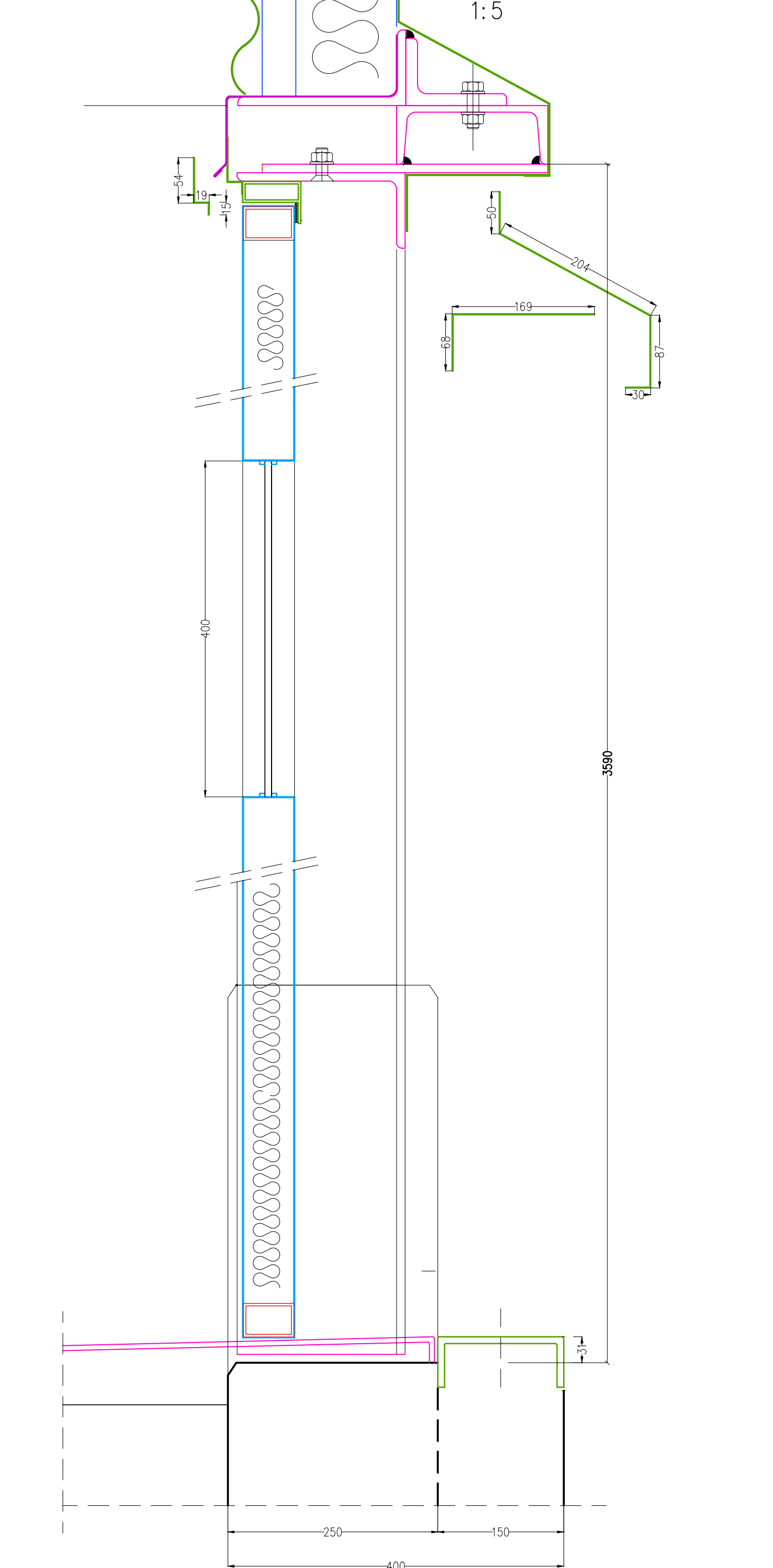

SEZ: A—A

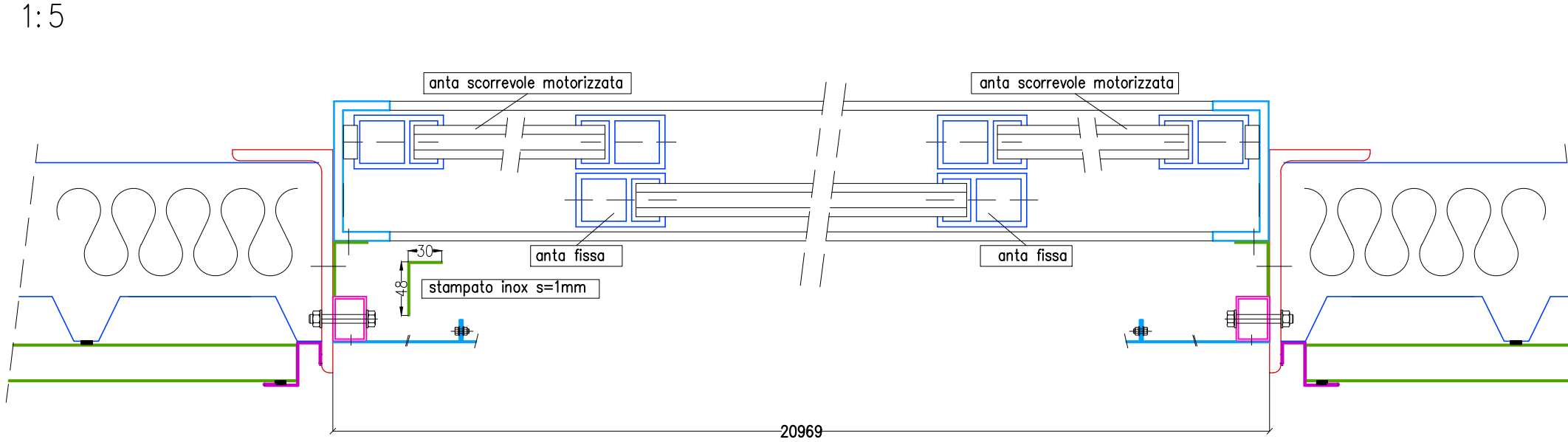

PROSPETTO EST

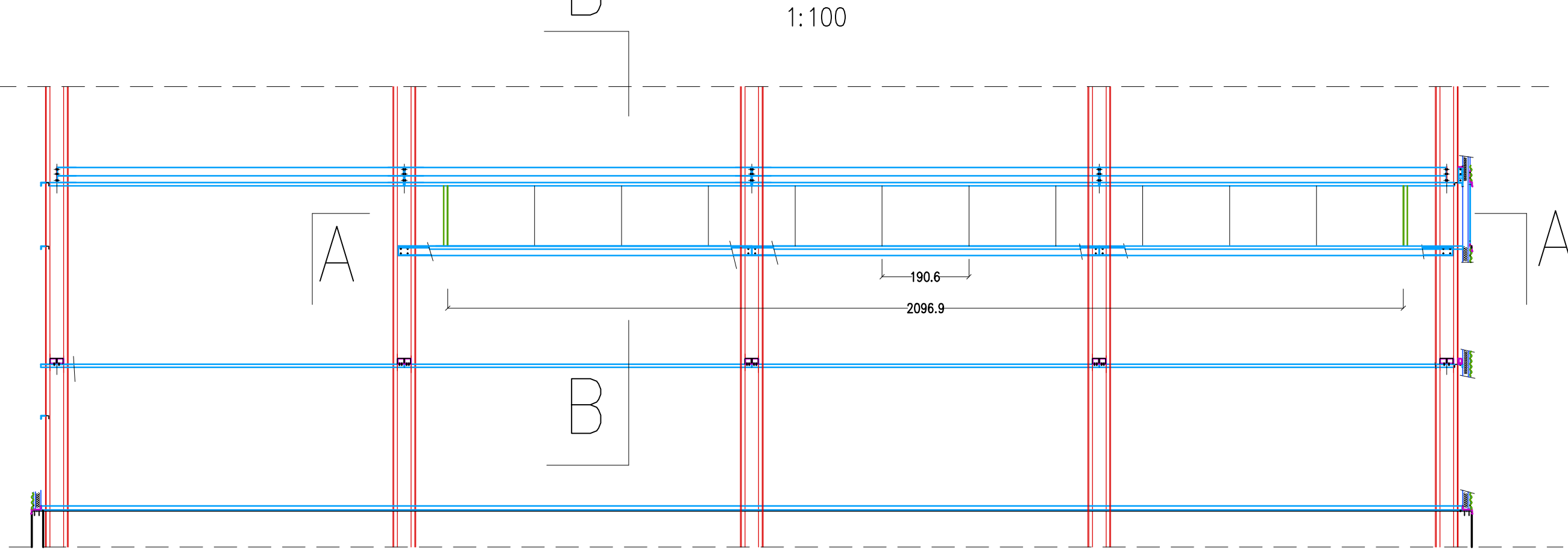

SEZ: B-B

